

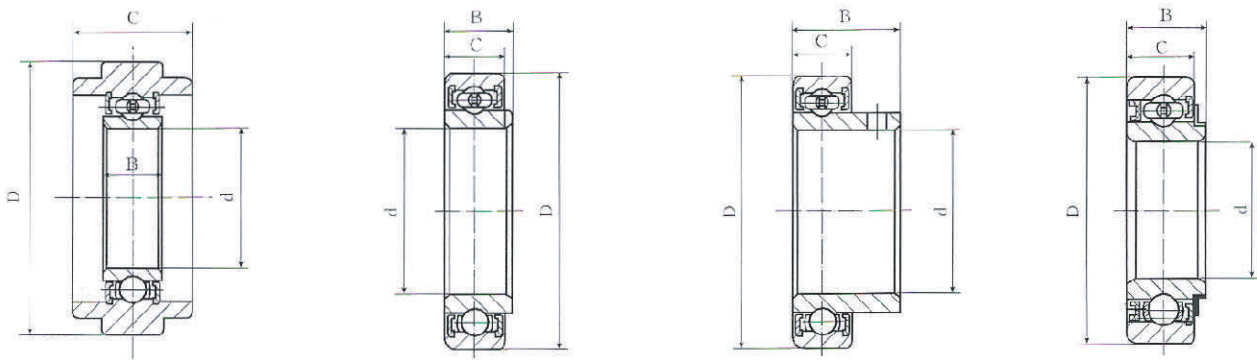

非标准轴承 NON-STANDARD BEARING



轴承代号 Bearing No.	外形尺寸 (in)		Dimensions (mm)		重量 Weight (KG)	备注 Remark
	d/H	D	B	C		
17012338-C1	45.400	62.000	19.00		0.212	
17012336-C1		9.000	14.00		0.007	
6208HEX	38.500 × 38.500	80.500	17.40		0.289	
628HEX EMQ	38.380 × 38.380	86.328	16.16		0.325	
411280	30.000	72.000	28.00		0.510	
306ZH	30.000	72.000	28.00		0.511	
K61810	50.000	80.000	33.00		0.960	
40BW04	40.000	85.000	22.00		0.303	
110BFFF	38.227 × 38.227	80.340	47.70		0.511	
WAI63305C3	25.000	62.000	25.40		0.300	
406KA	30.000	90.000	23.00		0.690	
S1701318-K2	42.500	65.000	1.50		0.022	
S1701326-K2	54.000	60.000	32.00		0.135	
S1701339-K2	66.200	64.690	7.50		0.026	
S1701343-K2	54.000	80.000	7.60		0.153	
529371	25.000	62.000	12.00		0.170	
50906KA	32.000	75.000	7.60		0.230	
XLS-4 ¹ /4SSK	111.303	147.638	31.75		1.150	
XLS-4 ¹ /4SSM	111.303	147.638	57.96		1.543	
XLS-6 ³ /4SSH	172.415	228.600	34.93		3.243	
XLS-6 ³ /4SSG	172.415	228.600	63.00		4.023	
211SSK	57.300	100.000	27.40		0.593	
215SSH	76.378	130.000	59.51		1.607	
F40679A	131.000	162.000	18.00		0.400	
F40680A	130.000	163.000	5.00		0.248	